

MINAM

Tekne Adı / Boat Name / Name des Boots

Dufour Grand'Large 335

Model / Fabrikat

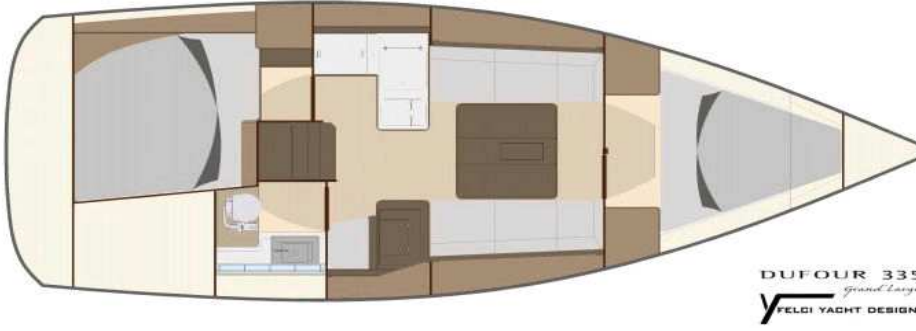

DUFOUR 335
Grand'Large
FELDI YACHT DESIGN

Teknik Özellikler:

Tam Boy	10.28 m
En	3.49 m
Su Çekimi	1.90 m
Ağırlık (boş)	5.45 ton
Su	380 lt
Mazot	160 lt
Yelken Alanı	56 m2
Klasik Ana Yelken, tam balen	
Sarma Cenova	
Motor	Volvo 29 hp
Kamara	2 + Salon
Yatak	4 + 2
WC / Banyo	1

Yüzme platformu ve duş
Bimini güneşlik
Serpinti körüğü
Tik kokpit
Elektrikli ırgat
Katlanır pervane
Kalorifer
Sıcak su
Hız / Derinlik
Rüzgar hızı ve yönü
Panel göstergeleri
Renkli haritalı GPS
Otopilot
VHF Telsiz
Elektrikli buzdolabı
220 V şarj sistemi
Barometre Termometre
Şişme bot + Dıştan takma motor
Radyo + CD/MP3 çalar

Technical Data:

Overall Length	10.28 m
Beam	3.49 m
Draft	1.90 m
Displacement	5.45 tonnes
Water	380 lt
Fuel	160 lt
Sail Area	56 m2
Fully battened mainsail with lazy bag	
Furling genoa	
Engine	Volvo 29 hp
Cabins	2 + Saloon
Berths	4 + 2
Heads / Showers	1

Swimming platform with shower
Biminitop
Sprayhood
Teak cockpit
Electric anchor windlass
Folding propeller
Warm air heating
Hot water
Speed / Depth
Wind speed and direction
Cockpit indicators
Color chartplotter
Autopilot
VHF Radio
Electric fridge
220 V recharging system
Baro-/Thermometer
Inflatable dinghy + outboard motor
Radio + CD/MP3 player

Technische Daten:

Länge über alles	10.28 m
Breite	3.49 m
Tiefgang	1.90 m
Verdrängung	5.45 tonnes
Wassertank	380 L
Dieseltank	160 L
Segelfläche	56 m2
Latten-Grossegel m. Lazy Bag	
Genua-Rollreiffanlage	
Motor	Volvo 29 PS
Kabinen	2 + Saloon
Kojen	4 + 2
WC und Dusche	1

Badeplattform mit Dusche
Biminitop
Sprayhood
Teak cockpit
Elektrische Ankerwinde
Faltbare Propeller
Warmluftheizung
Warmwasser
Speedometer / Echolot
Windmessanlage
Cockpit-Anzeigen
GPS m. Farbplotter
Autopilot
VHF-Seefunkgeraet
elektr. Kuehlaggregat
Batterieladegeraet
Baro-/Thermometer
Schlauchboot + Aussenbordmotor
Stereoradio/CD/MP3-Spieler

Yelkenli Yachting Ltd.

www.yelkenli.com

+90 312 4174705